

◆ Installing operational pictures

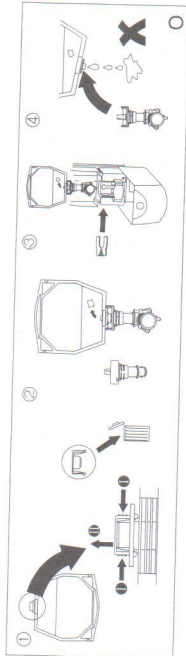
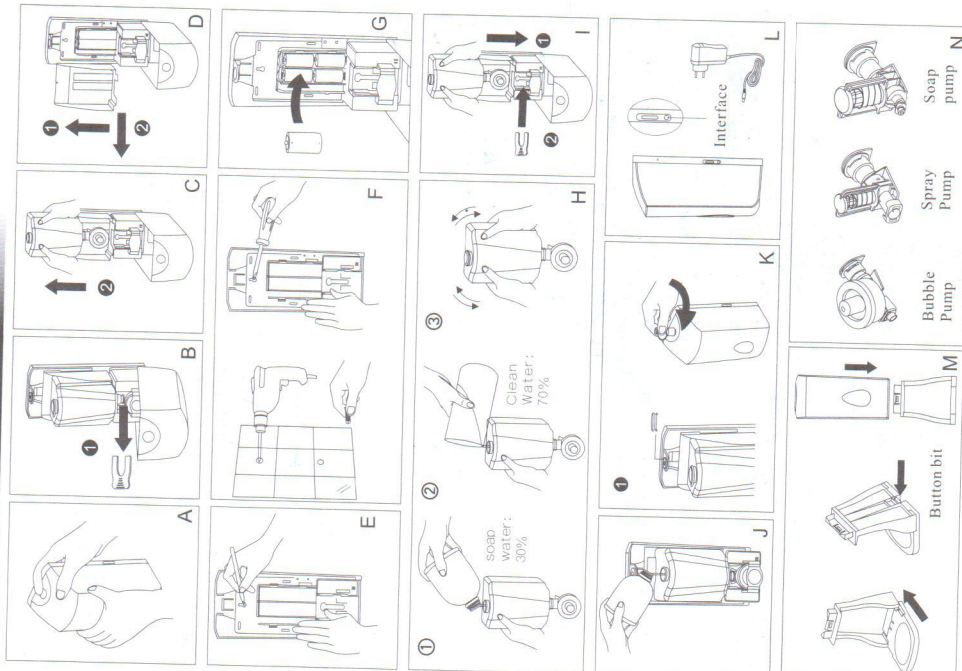

◆ Installation Steps

- Step 1**-A pic shows, index finger press the key and push it toward your hand.
- Step 2**-B pic shows, pull out the pump fixed plate based on the arrow, take away the bottle based on the arrow.
- Step 3**-C pic shows, take out the bottle
- Step 4**-D pic shows, take away the support board based on the arrow.
- Step 5**-E pic shows, use the bottom cover as model, marl on the wall, it is convenient to install.
- Step 6**-F pic shows, use the hole dicking machine dick the hole in the marking places, insert the Rubber plug accompany with the machine. Use the screw to fix the bottom cover on the wall.
- Step 7**-Gpic shows, put the 4 pcs 1.5V battery in the correct method.
- Step 8**-H pic shows, if you need to change the soap water into foam water, you can ①put 30% soap water into bottle, ②than put into 70% clean water, ③at last, cover the lip and mix the liquid.
- Step 9**-I pic shows, put the bottle into the machine.
- Step 10**-J pic shows, if you use the foam soap water, you can direct put the foam soap water into the bottle.
- Step 11**-K pic shows, take away the key lock, insert the key and Clockwise 90degrees, then you can lock the dispenser.
- Step 12**-L pic shows, AC adapter can be used.
- Step 13**- If you bought the desktop, please take M pic as reference.
- Step 14**- N pic shows, there are 3 different kinds of functions, use the corresponding pumps if you change the liquid.
- Step 15**- O pic shows, the plastic bag can be used

◆ Notes and Maintenance

- 1: Please add the soap if the volume is lower than 1 cm.
- 2: The valid distance for the machine is about 10cm
- 3: Please replace the battery if there is continuing B B sound when there is no obstacles near 14cm.
- 4: Avoid anything stuck in the pump, clean the liquid without any impurity.
- 5: Please use it frequently, the liquid may solidify if long time no use.
- 6: clean the product
- A: the keep the bottle empty if not using, clean it with cloth and take out the battery
- B: don't clean the dispenser in the water, it will damage the PCB
- C: Cleaning the cover of the product by using the wet and dry cloth, clean the battery box only using dry cloth.
- D: Don't clean the product by using Corrosive chemical, in case the Cover is damaged.
- 7: If it is leaking, please replace another pump.
- 8: if what you bought is bubble pump, please use bubble water, don't use the thick liquid. if using hand washing liquid, please follow the proportion 30% hand washing liquid, 70% water, mix together until it becomes water, so that it can produce more bubble.

◆ Suggestion

The hand washing liquid Concentration is different according to different areas, which cause the liquid can't pressed out, if this case, we strongly use the pure water to test it until the water come out. Then pull out the remaining water, it is normal to find the water inside the dispenser.